

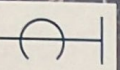

Howth Castle Masterplan

Presentation to Fingal County Council

 TETRARCH
CAPITAL

Hopkins Architects

25/06/2020



Hopkins Architects - Our office



Portcullis House, Westminster

Glyndebourne Opera House, Sussex

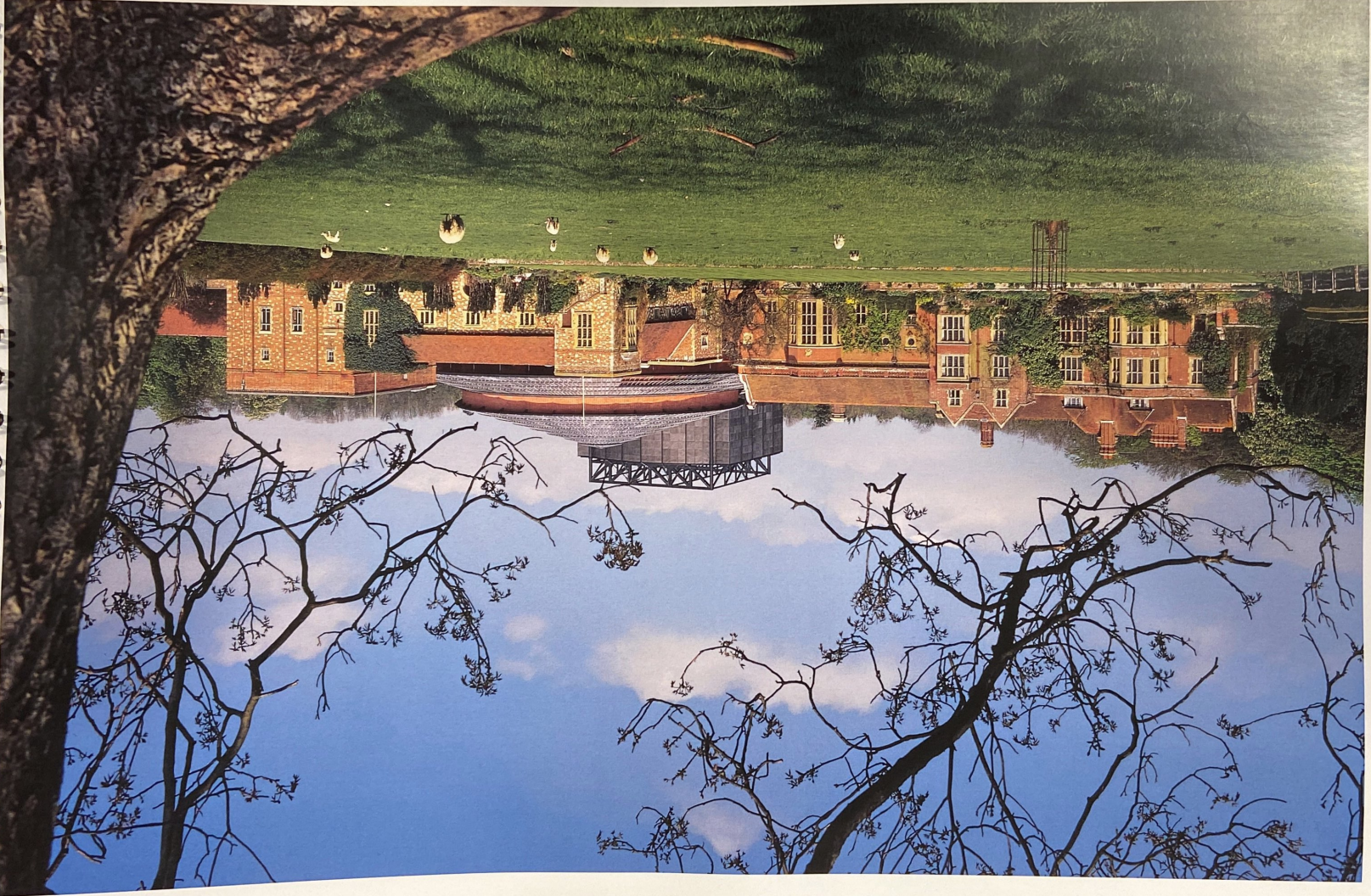

Lo





Glyndebourne Opera House, Sussex





London 2012 Olympic Velodrome

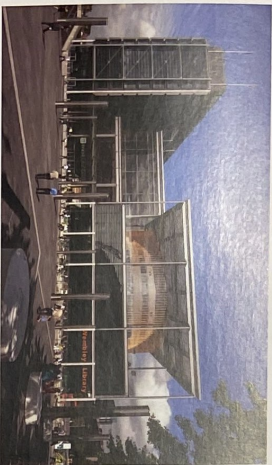

Civic and Culture



Education



Healthcare



Masterplanning



Refurbishment & Restoration



Research and Science

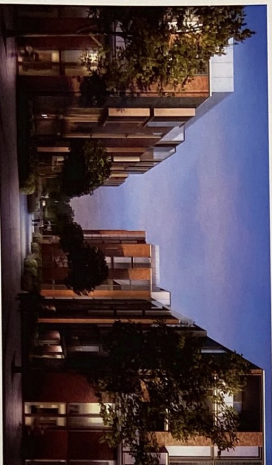

Residential



Sport & Leisure

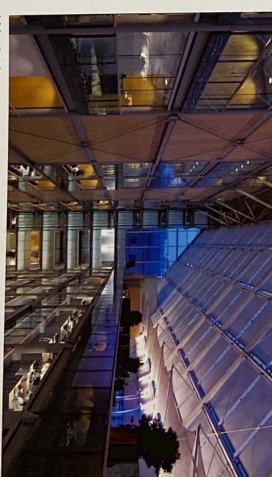

Workplace

Sectors



Hastings Station Plaza

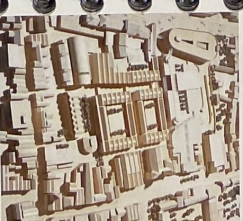

Northgate Development, Chester



Northingham East Side Regeneration

Masterplans

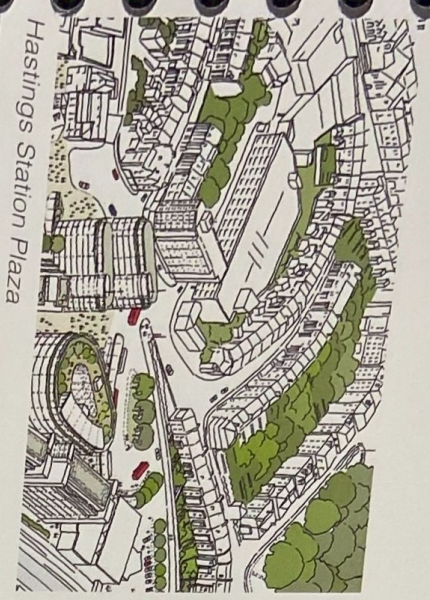

Hastings Station Plaza

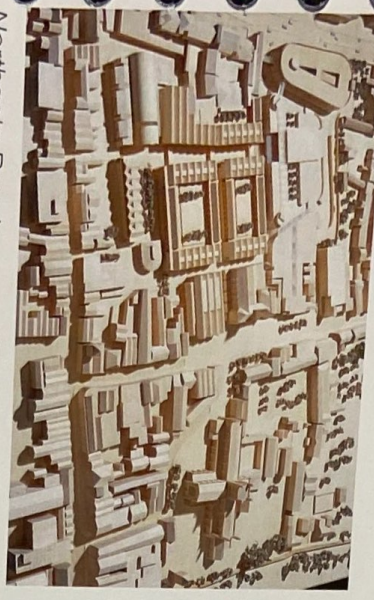

Northgate Development, Chester



Nottingham East Side Regeneration



Belfast Royal Exchange



Hull Strategic Framework Plan



Greenwich Town Centre



Walsall Strategic Framework

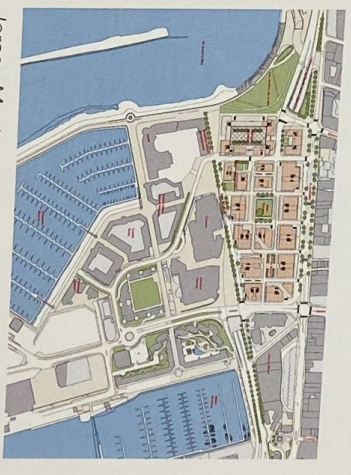

Jersey Masterplan



Leicester Waterside Sustainable Development



Wai Tan Yuan, Shanghai Urban Design



Bury St Edmunds



North St Heller, Jersey Masterplan

Masterplans

Jersey Masterplan



The Arc, Bury St Edmu

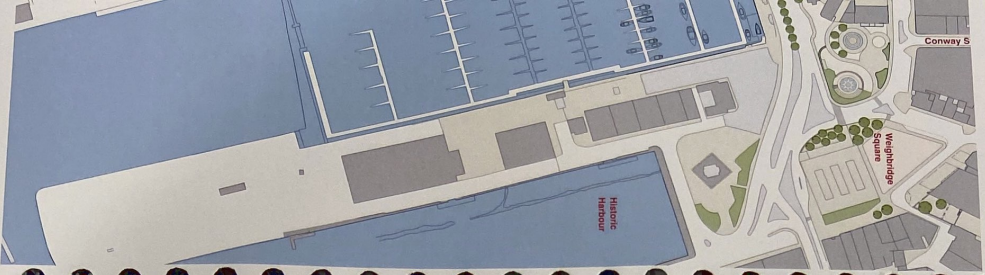

The Arc, Bury St Edmunds

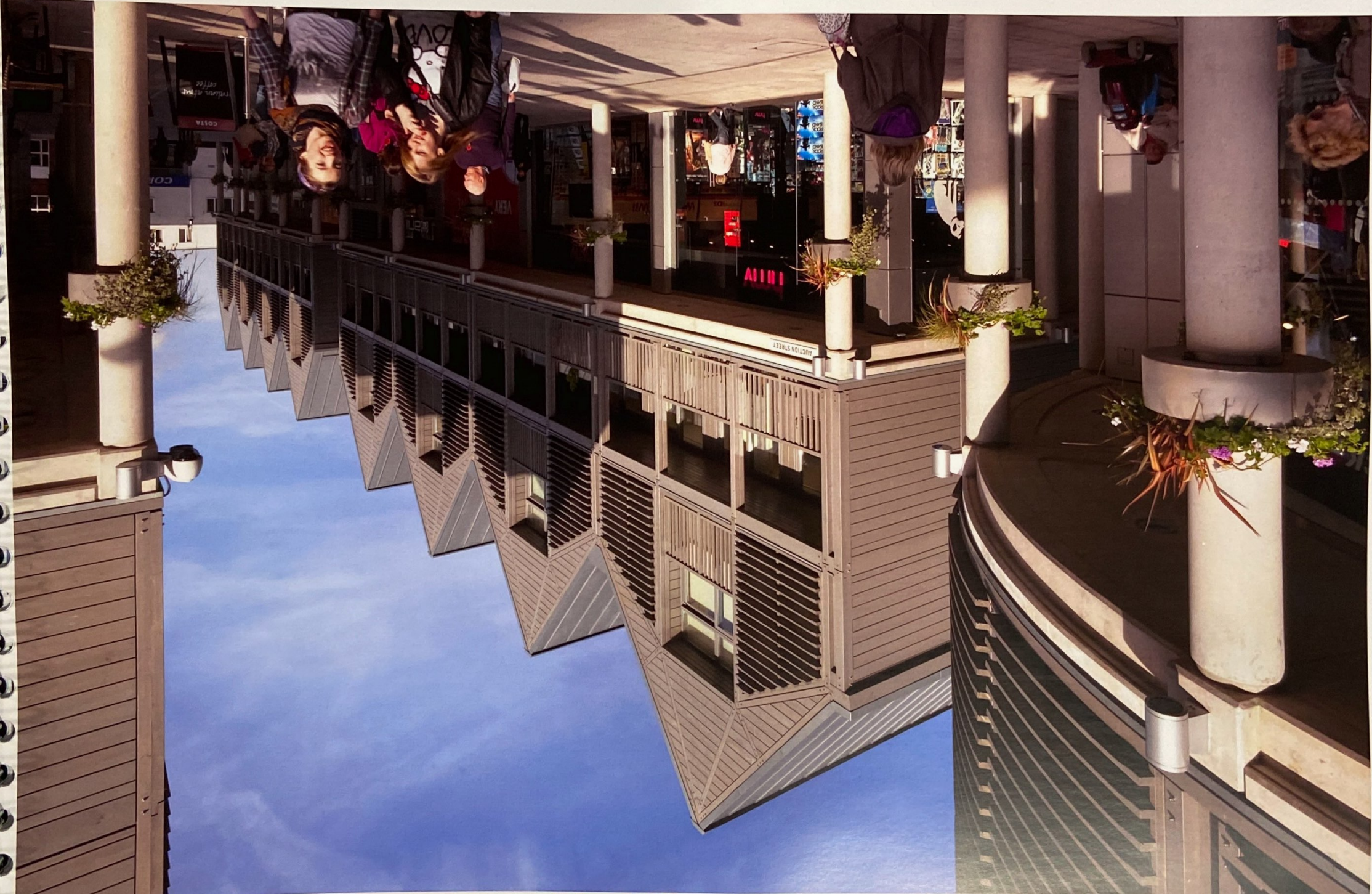

The Masterplan





The Masterplan





The development of the Howth Castle Demesne is an amazing opportunity to provide a much improved amenity for Howth as well as creating better connections across the estate.



-  Site Red Line boundary
-  Architectural Conservation Area
-  Special Area Amenity Order Zone (SAAO)

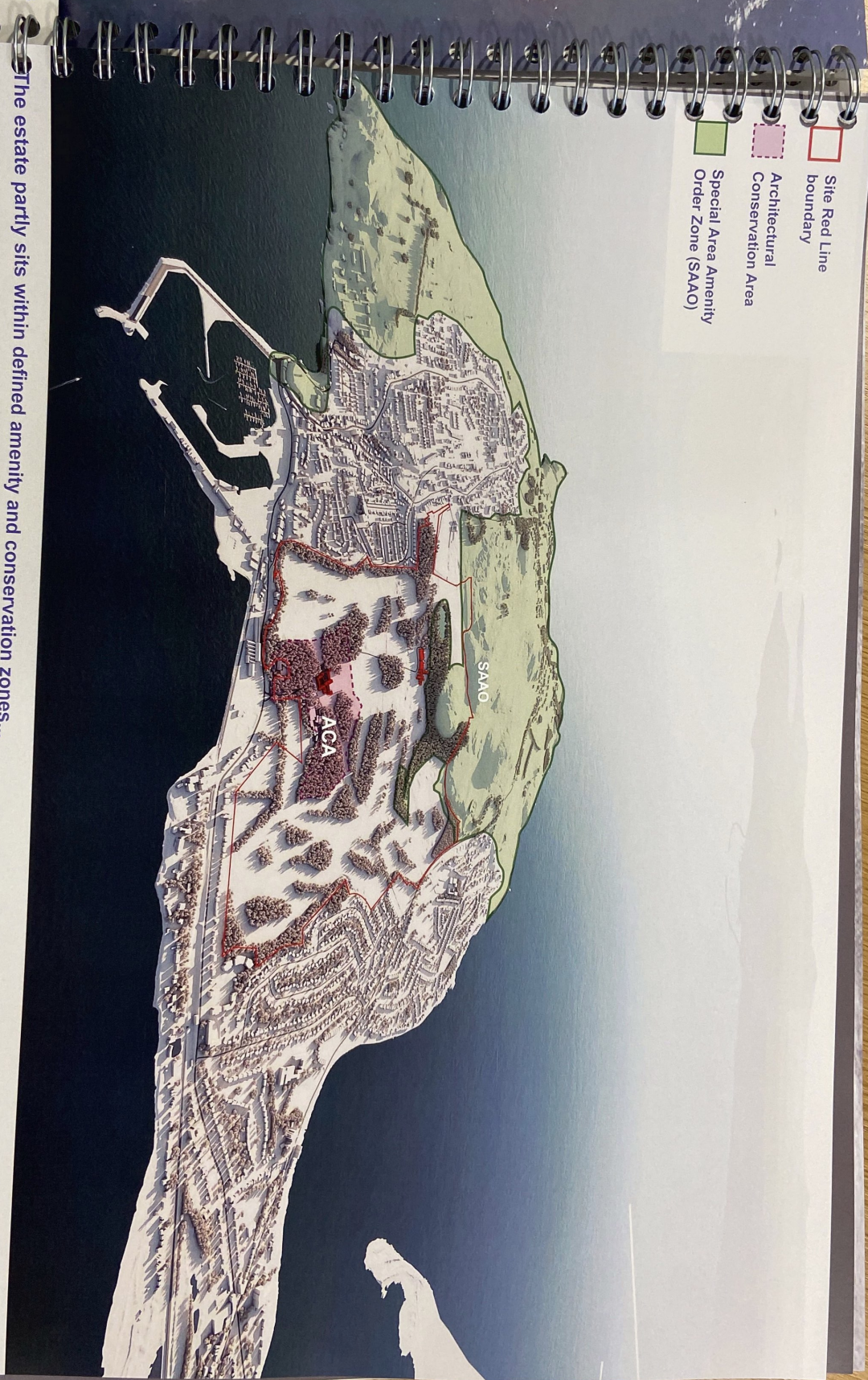

ity for Howth as well as
Howth Castle Masterplan

The estate partly sits within defined amenity and conservation zones...

Howth Castle Masterplan

Site Red Line boundary

Architectural Conservation Area

Special Area Amenity Order Zone (SAAO)



The estate partly sits within defined amenity and conservation zones...



which prescribes the protected views from the upper part of the estate.

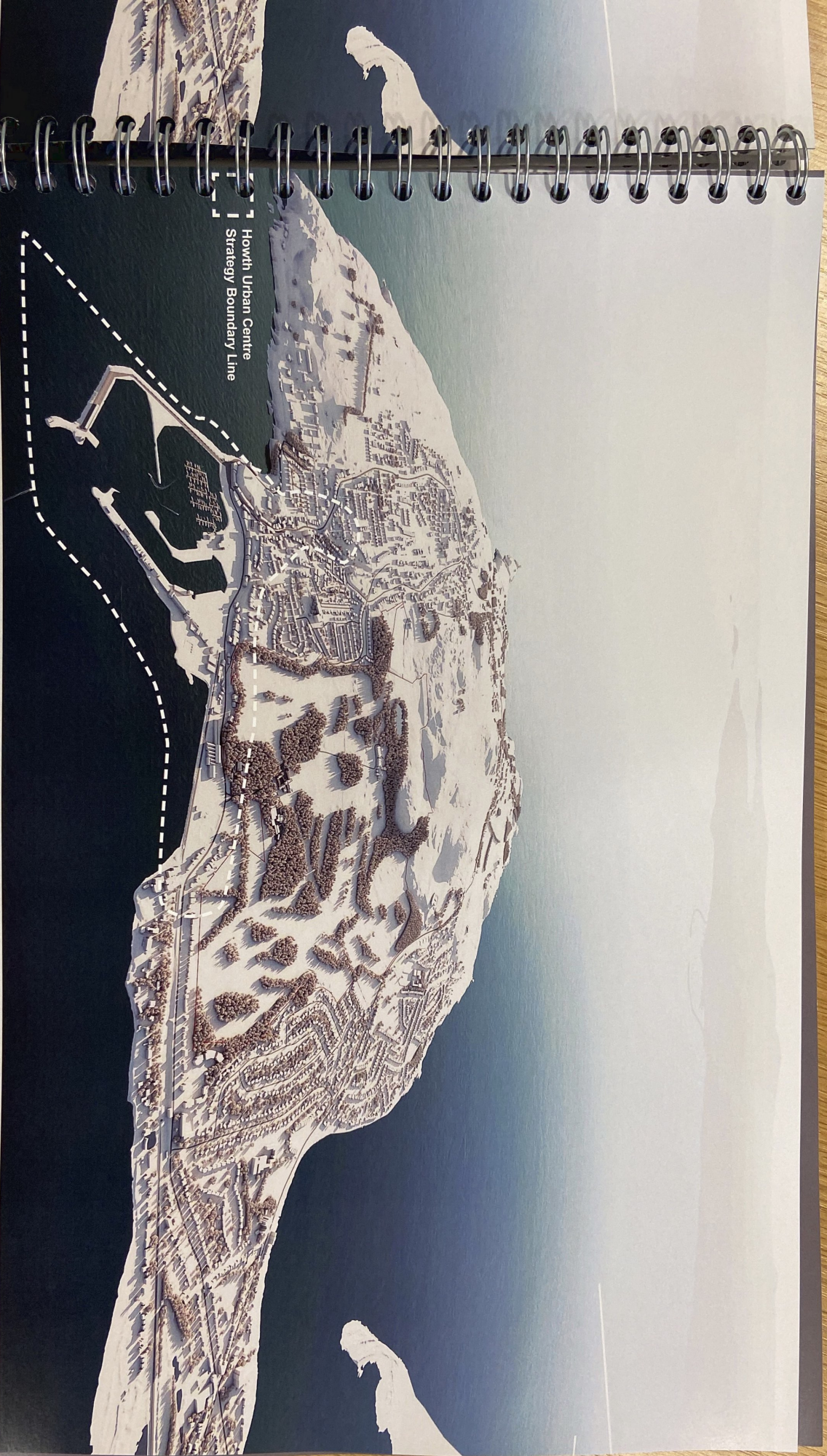

Howth Urban Centre
Strategy Boundary Line

The Howth Urban Centre Strategy acknowledges the benefits of expansion and improvements to the harbour frontage.

Which prescribes the protected views from the upper part of the estate.





Howth Urban Centre
Strategy Boundary Line

Howth Urban Centre Strategy acknowledges the benefits of expansion and improvements to the harbour frontage.

Much of the developable area of the estate is within 1 km of the station.



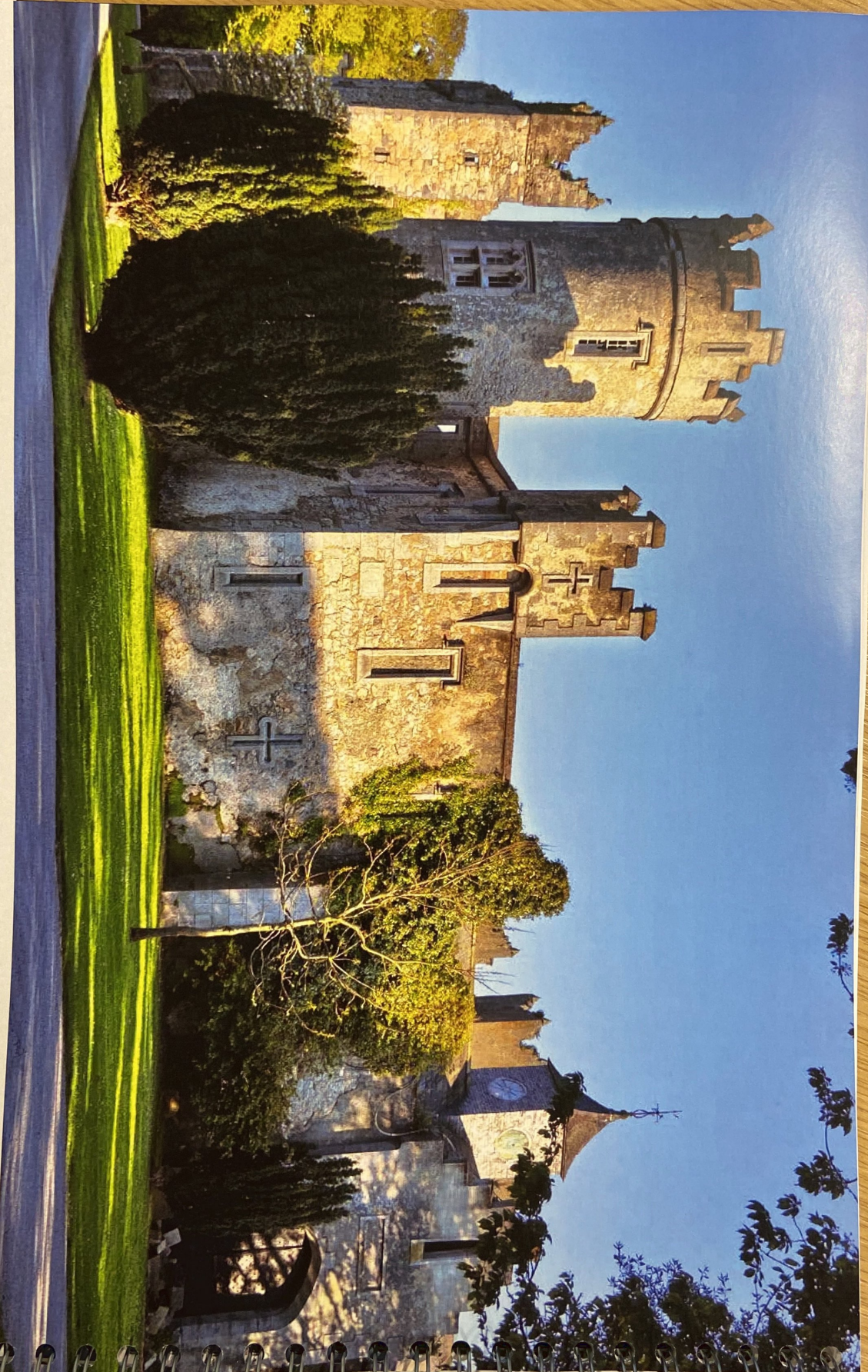

Howth Castle

Howth Castle Masterplan

The e

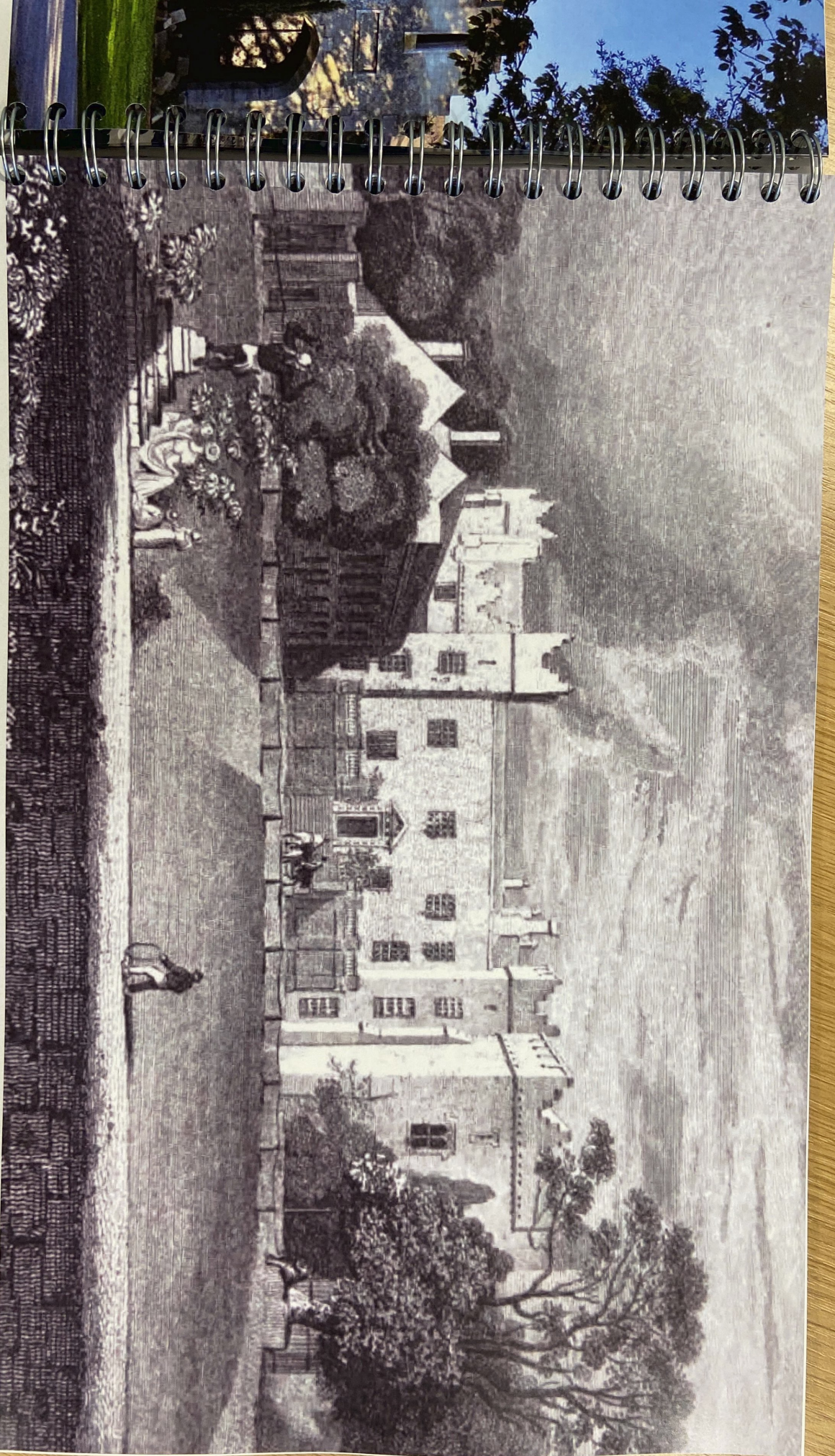

The castle has been under one family's ownership for over 800 years...









Historic map of Howth

Records show the castle in its current position from the 15th Century...

Since this time it has been subject to continual development.



	15th Century
	16th Century Enclosure walls and hall added
	17th Century Renovated c1738
	19th Century Remodelled by Sir Richard Morrison
	1911 - Sir Edwin Lutyen Various interventions
	1990 Conservatory added to kitchen wing

'A Prospect of Howth', oil painting, c1740



By the 18th Century the castle was remodelled in the Georgian style, and the estate was well established.

Howth Castle Masterplan

The castle was

Early 20th cen





Early 20th century postcard of Howth Castle showing works by Richard Morrison

The castle was remodelled again in the 19th Century, with contributions from a variety of architects, including Sir Richard Morrison's work on the west wing...

Howth Castle Masterplan

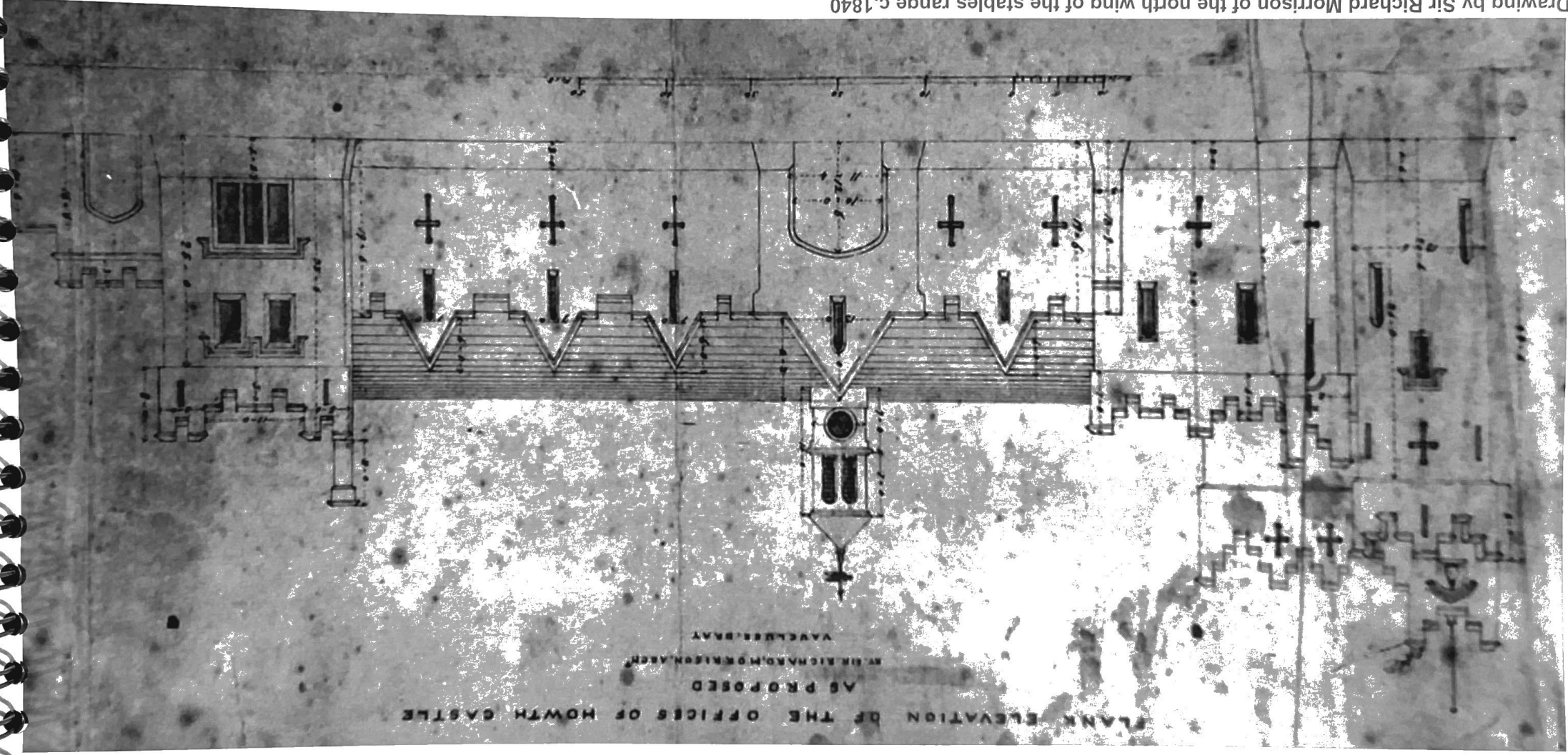

FLANK ELEVATION OF THE OFFICES OF HOWTH CASTLE
AS PROPOSED
BY SIR RICHARD MORRISON, ARCHT.
VAN DER BRAY

Drawing by Sir Richard Morrison of the north wing of the stables range c.1840

who also redeveloped the stables range.



Photograph of the Library Interior



Photograph of the Library Tower construction, Lutjens
(Gaisford-St.Laurence Archive)

Sir Edwin Lutjens, an internationally regarded architect, extended and remodelled the castle in 1910-1911, adding a four storey library block...

who also redeveloped the stables range.

Drawing by Sir Richard Morrison of the north wing of the stables range c.1840

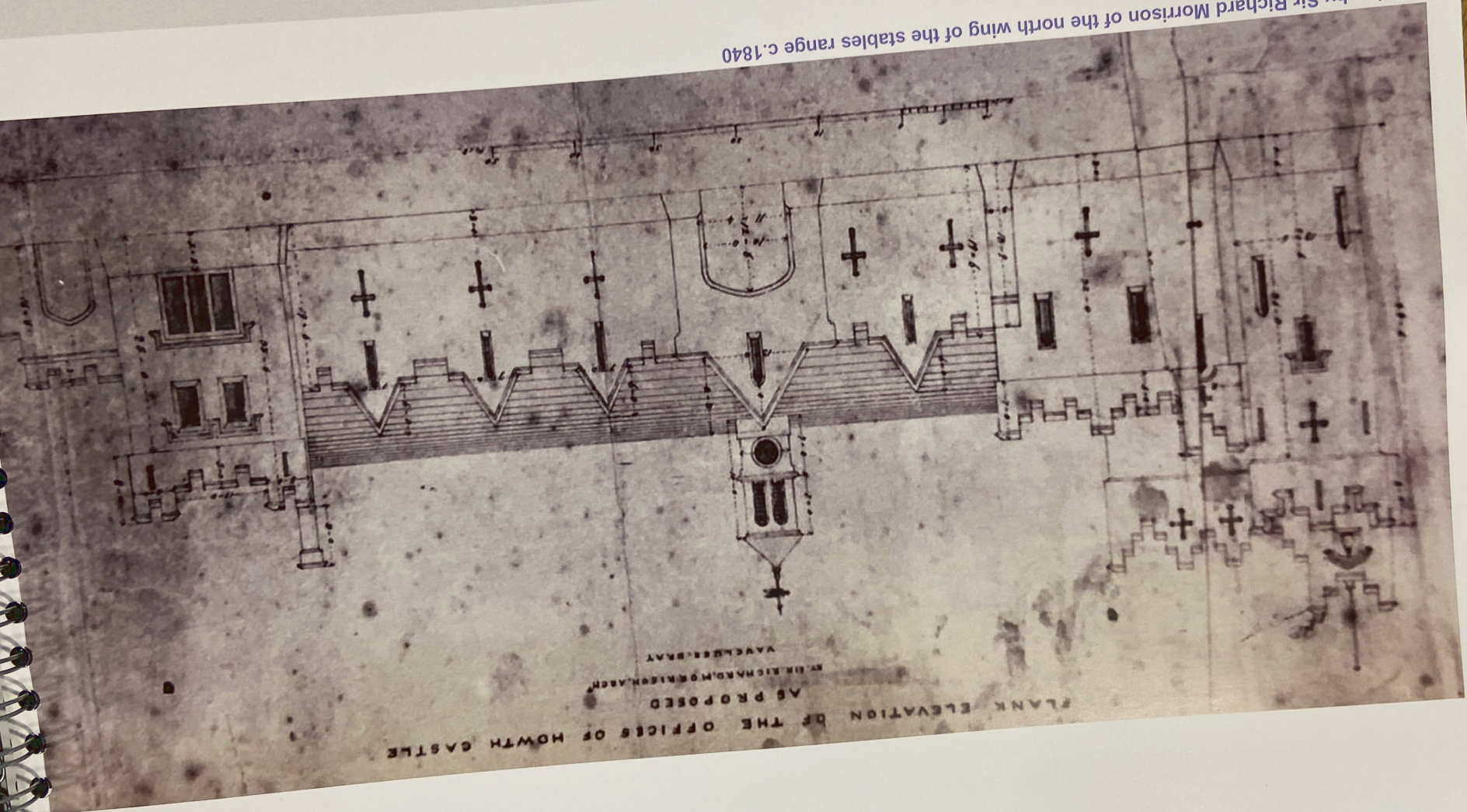

FLANK ELEVATION OF THE OFFICES OF HOWTH CASTLE
AS PROPOSED
BY SIR RICHARD MORRISON, ARCHT.
VALENTINE, BRAY



Photograph of the Library Tower construction, Lutyens
(Gaisford-St.Laurence Archive)



Photograph of the Library Interior

Howth Castle Masterplan

Sir Edwin Lutyens, an internationally regarded architect, extended and remodelled the castle in 1910-1911, adding a four storey library block...



Including a new stair and gardens to the west of the drawing room.



Howth Castle Masterplan

The ground f

Library
Drawing R



The ground floor rooms have exceptional interiors, some of which were renovated by Lutjens.

Library



Drawing Room



Dining Room



The castle was extensively landscaped, including a walled market garden, and a walled garden lined with beech hedges...

Howth Castle Masterplan

Headin

Entran



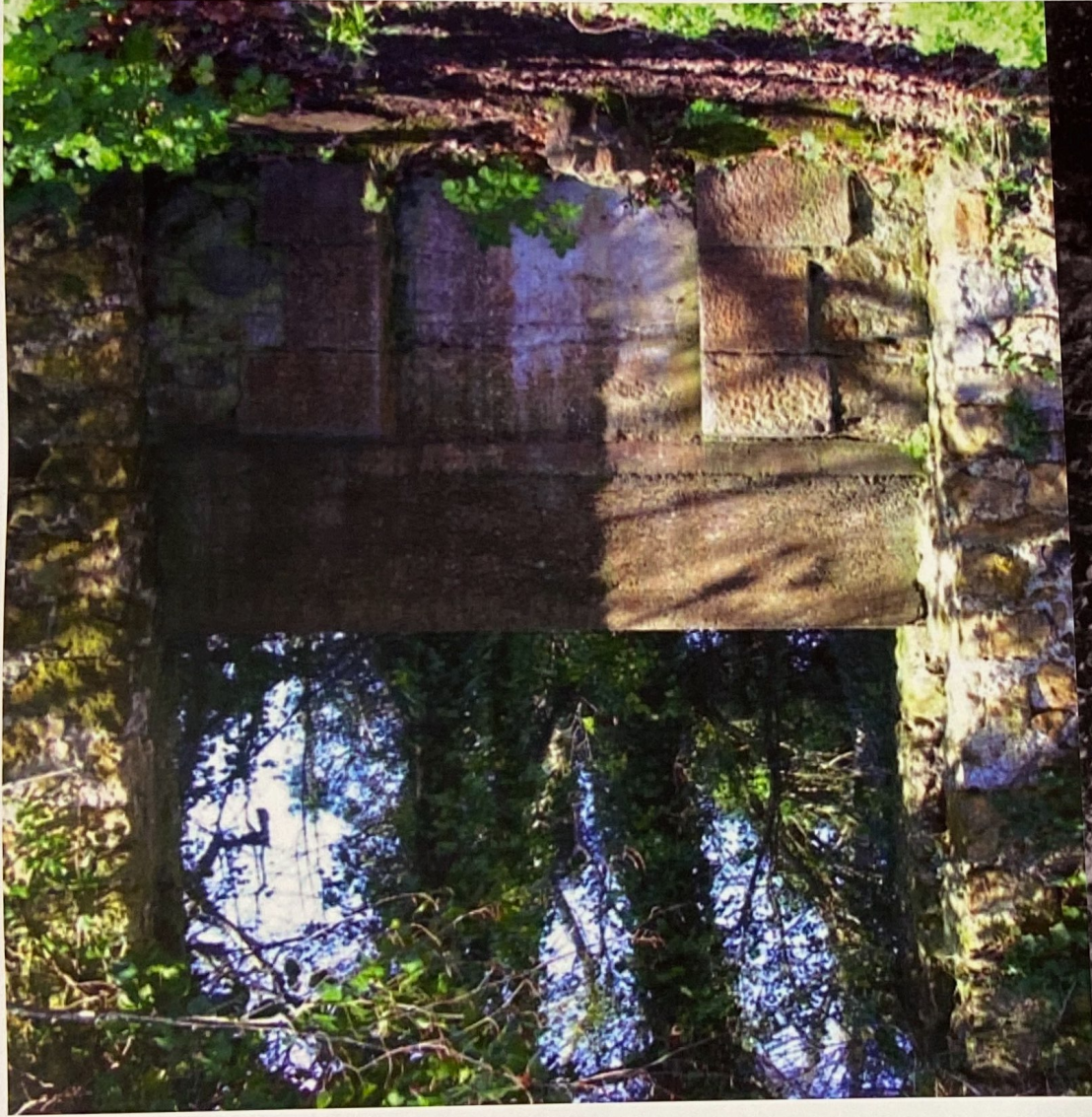

Entrance to the Children's Garden from the walled garden, c.1911 and today

leading to the Children's Garden designed by the renowned horticulturist Gertrude Jekyll, with whom Lutyens also collaborated with.



Despite continual improvement works, the demesne proved too difficult to maintain, and parcels of land were sold...

Howth Castle Masterplan

1837 - 1842

and with the



1837 - 1842

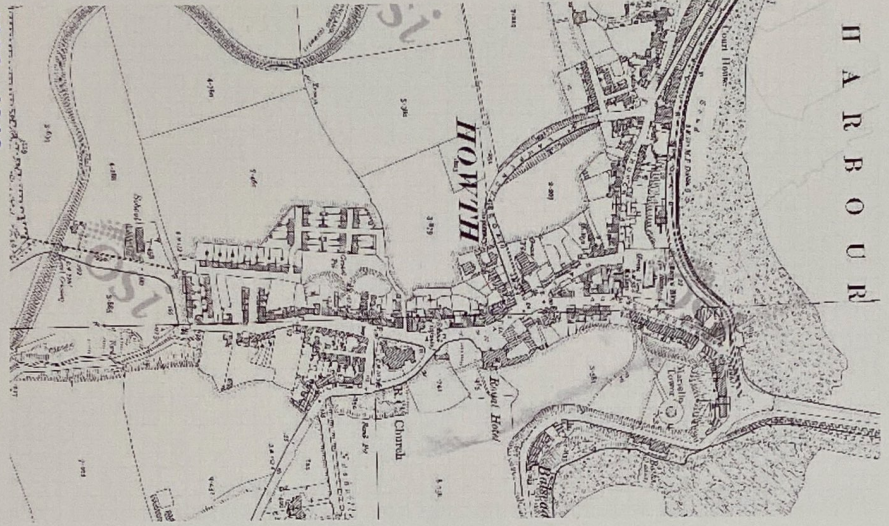

1888 - 1913

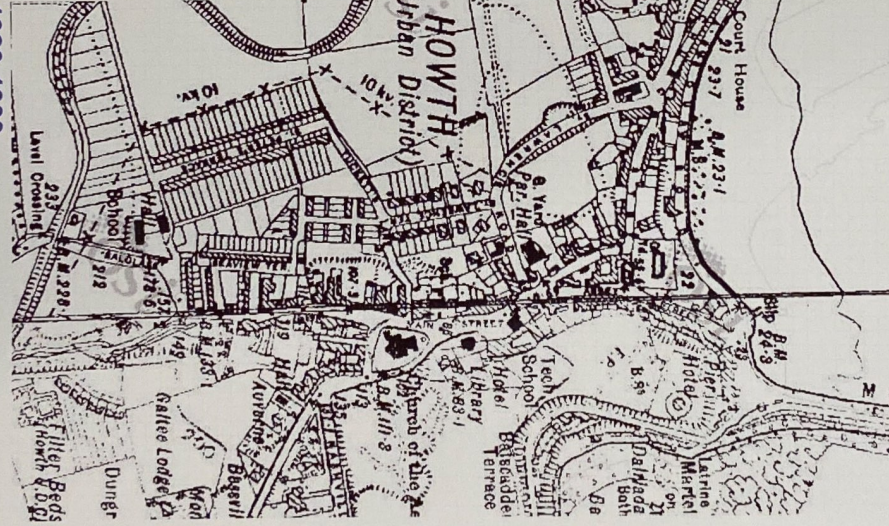

1920-1930



Present Day

and with these sales of land Howth village began to develop.